

ZIEGELBAUER SEPTIC SERVICE LLC

PO BOX 33

MALONE, WI 53049

920-795-4219

TODAY'S DATE: March 20, 2024

Here is a list of things that need addressing for the septic system located on the property at: 310 North Turtle Bay Road, Elkhart Lake, WI 53020;

- Do to the 'lift pump' taking a lengthy time of recycling for dosing purposes, the ends of the absorption laterals should be located. Turn-ups are recommended to be installed. And then flushed with a pressure test preformed.
- Electric junction box is cracked and no longer is water-tight. To make this code-compliant, junction box needs be replaced.
- Lift-tank (PC manhole) cover has a chipped out piece and should be replaced.
- High water alarm wire is running thru a joint between the riser and tank lid. This is not code compliant and needs be redone/rewired.
- We no longer go inside residential homes, due to Covid. Therefore it could not be determined if the high water alarm is operable.

Ziegelbauer Septic Service LLC

Private Onsite Wastewater Treatment System Evaluation

Property Information

Current Owners Name: Jose + Kathleen Parades
Property Address: 310 North Turtle Bay Road, Elkhart Lake, WI 53020
Mailing Address: matt @ prvhomes .com
Are repairs needed: Yes - No: (see below) See attached sheet...

house structure any more.

System Information

Is there a sanitary permit in file with the county? Yes No Permit # 3427 N/A
Type of structure: 1 or 2 family dwelling - number of bedrooms 3
 Public / Commercial - Describe us _____ DWF _____ GPD _____
Date of installation: 1983 (if known) or Estimated age: _____ (year)
Was structure occupied? Yes No Number of occupants: Cottage usage
Time vacant: _____ (in months) Did snow cover exist? Yes No

Tank Information

Type of tank & capacity: Septic: 1000 gallons Dose: 1000 gallons Holding: _____ gallons
Total number of tanks onsite: (circle one) one two three four five other: _____
Date pumped: 3/19/2024 Pumping company: Ziegelbauer Septic Inc LLC
Tank material: concrete steel fiberglass other: _____
Condition of tank(s): mild spalling of upper interior walls + ceiling
Condition of baffle(s): PVC baffles - intact
Condition of manhole(s): both above grade with locks installed
Condition of chains, locks and warning labels: code-compliant
Is tank equipped with an effluent filter? Yes No Has filter been cleaned? Yes No
Is tank equipped with an alarm system? Yes No Is alarm operational? Yes No
Do any domestic wastewater drains bypass the system? No Yes; explain _____
Does this system contain a pretreatment device? No Yes (if yes, was bag of changed?) Yes No
Remarks: _____

undetermined - do not go in

Absorption Area

Type of septic system: At-Grade Mound In-ground pressure Cesspool
 Conventional (Bed Trench Dose Gravity)
 Drywell Outfall Other _____
Is any area of soil absorption system soft or spongy? No Yes, explain; _____
Does soil absorption system have vent(s) or observation pipe(s)? No Yes how many? _____
Is liquid evident in vent(s) or observation pipe(s)? No Yes (if yes, number of inches _____)
Remarks: could not locate observation towers

Saturation Test

Amount of gallons induced into septic tank: _____ (Add tracing dye if observation pipe(s) do not exist)
 (If system is equipped with effluent pump, cycle minimum of one time) _____ times pump cycled
 Did effluent level in septic tank fluctuate during dosing? No _____ Yes (If yes, # of inches _____)
 Is liquid evident in observation pipe(s) before dosing? _____ # of inches. (which pipes if multiple?) _____
 _____ # of inches after. (which pipes if multiple?) _____

Was backflow observed after septic tank(s) were pumped out? No _____ Yes
 Are any areas wet or spongy on or around soil absorption system after dosing? No _____ Yes;
 Where: _____

Any outfall of effluent noted? No _____ Yes

Comments: Note: effluent pump was cycled 1-time; it took approx. 45-mins to cycle the pump 1-time.

 • Could not locate observation towers

Wisconsin statutes of a failing system (Per Section 145.245 (4)) (circle one that applies)

Discharge of sewage into surface water or ground	Yes <input type="checkbox"/> No <input checked="" type="checkbox"/>
Introduction of sewage into zones of seasonal saturation which adversely affects POWTS operation.	Yes <input type="checkbox"/> No <input checked="" type="checkbox"/>
Discharge of sewage to a drain tile or into zones of bedrock.	Yes <input type="checkbox"/> No <input checked="" type="checkbox"/>
Discharge of sewage to the surface of the ground	Yes <input type="checkbox"/> No <input checked="" type="checkbox"/>
Failure to accept sewage and backup of sewage into the structure	Yes <input type="checkbox"/> No <input checked="" type="checkbox"/>

Site Diagram

See attached sheet for diagram

Not to scale

Inspector information

Comments: _____

The information on this report is based upon observations made on evaluation date only. This form does not grant any warranty, expressed or implied

Company: Ziegelbauer Septic Svc LLC Credentials: WI DNR # 602 POWTS Maintainer # 976264
 Inspector: Simon Ziegelbauer Signature: [Signature] Evaluation Date: 3/19/2024

NOTE: Installed near pump
Zoeller 163 automatic
5/29/96

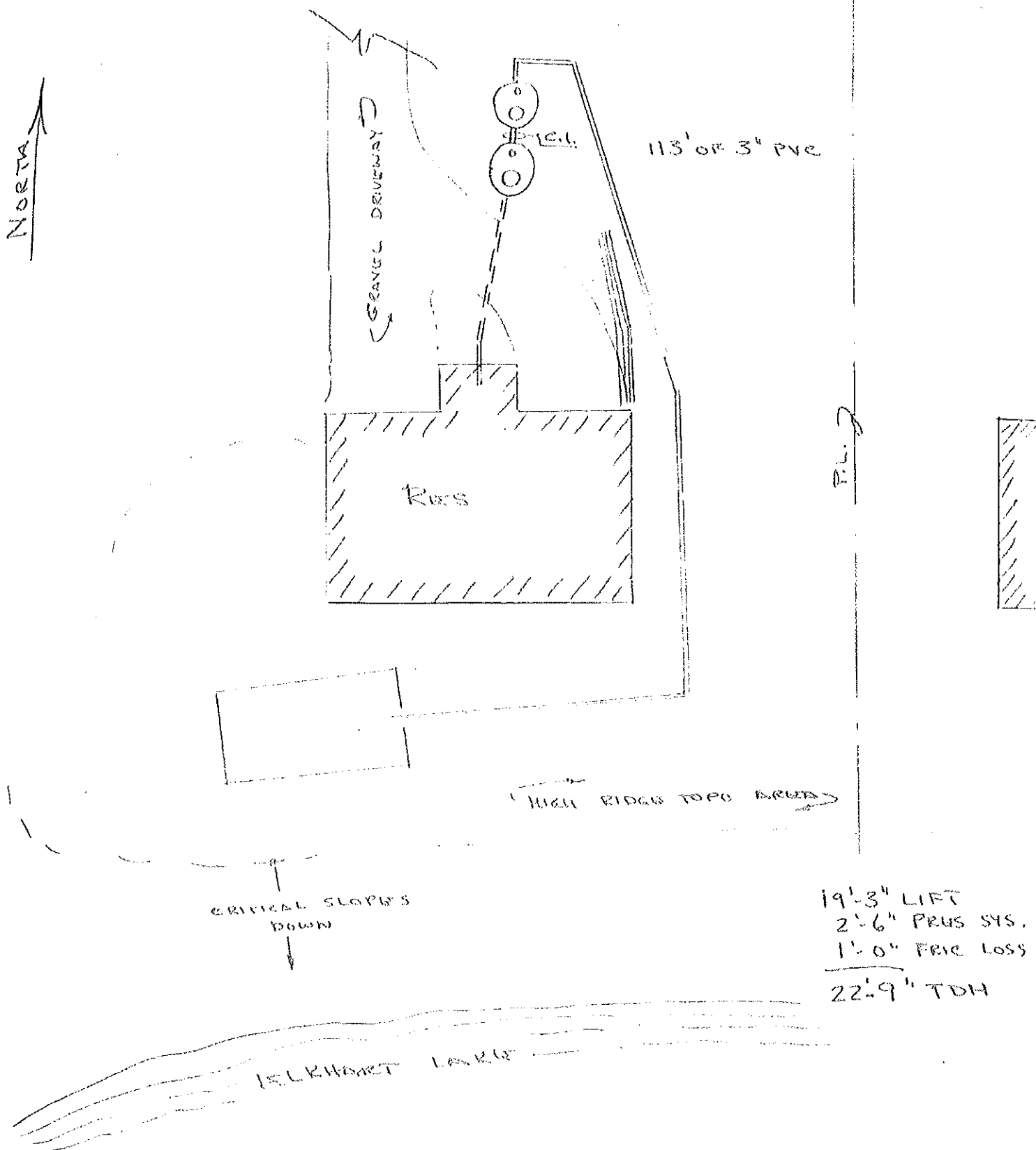

19'-3" LIFT
2'-6" PVE'S SYS.
1'-0" FRIE LOSS

22'-9" TDH