

2023 Property Records for Village of Glenbeulah, Sheboygan County

October 31, 2023

Tax key number: 59131611540

Property address: 203A Scott St

Traffic / water / sanitary: Light / Municipal water / Sewer

Legal description: ORIG. PLAT DIV. 2 E PRT LOT 20 LYING E OF E LN DILLINGHAM ST, & ALL LOTS 21, 22 & 23, BLK 9.

Summary of Assessment	
Land	\$75,800
Improvements	\$144,100
Total value	\$219,900

Qty	Land Use	Width	Depth	Square Feet	Acres	Land		Special Tax Program	Assess Value
						Water Frontage	Tax Class		
1	Residential	150	300	45,000	1.033	Pond (Prime)	Residential		\$75,800

Residential Building			
Year built:	1975	Full basement:	820 SF
Year remodeled:		Crawl space:	
Stories:	1 Story	Rec room (rating):	
Style:	Cottage	Fin bsmt living area:	
Use:	Single family	First floor:	820 SF
Exterior wall:	Wood	Second floor:	
Masonry adjust:		Third floor:	
Roof type:	Asphalt Shingle +10	Finished attic:	
Heating:	Gas, forced air	Unfinished attic:	
Cooling:	No A/C	Unfinished area:	
Bedrooms:	2	Deck	100 SF
Family rooms:			
Baths:	1 full, 1 half		
Other rooms:	1		
Whirl / hot tubs:			
Add'l plumb fixt:			
Masonry FPs:			
Metal FPs:			
Gas only FPs:		Grade:	C-
Bsmt garage:		Condition:	Average
Shed dormers:		Energy adjustment:	No
Gable/hip dorm:		Percent complete:	100%



Total living area is 820 SF; building assessed value is \$69,400

611540

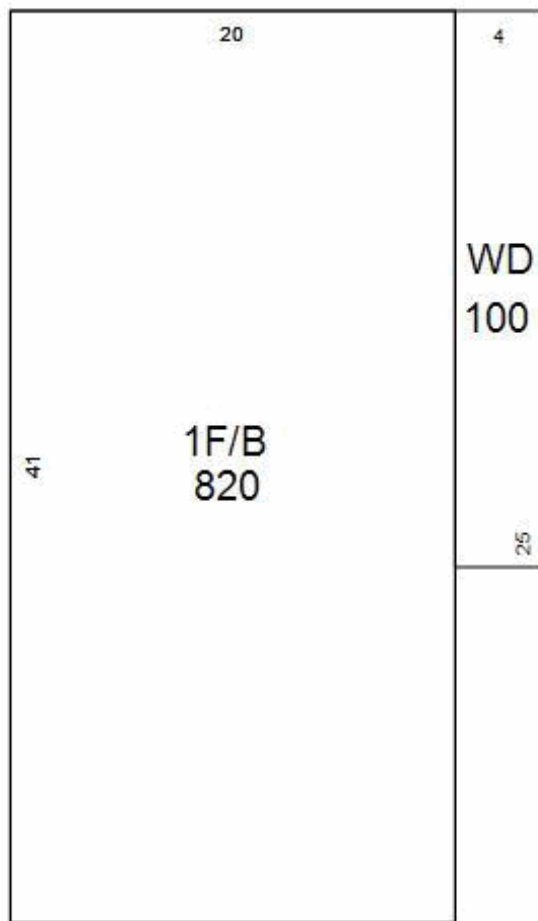

HOUSE #2

Residential Building			
Year built:	1925	Full basement:	216 SF
Year remodeled:		Crawl space:	
Stories:	1.5 Story	Rec room (rating):	
Style:	Residential O/S	Fin bsmt living area:	
Use:	Single family	First floor:	851 SF
Exterior wall:	Wood	Second floor:	252 SF
Masonry adjust:		Third floor:	
Roof type:	Asphalt Shingle +10	Finished attic:	
Heating:	Gas, forced air	Unfinished attic:	
Cooling:	No A/C	Unfinished area:	
Bedrooms:	2	Enclosed porch	126 SF
Family rooms:		Open porch	80 SF
Baths:	1 full, 1 half		
Other rooms:	2		
Whirl / hot tubs:			
Add'l plumb fixt:			
Masonry FPs:		Grade:	C-
Metal FPs:		Condition:	Average
Gas only FPs:		Energy adjustment:	No
Bsmt garage:		Percent complete:	100%
Shed dormers:			
Gable/hip dorm:			



Total living area is 1,103 SF; building assessed value is \$68,000

611540

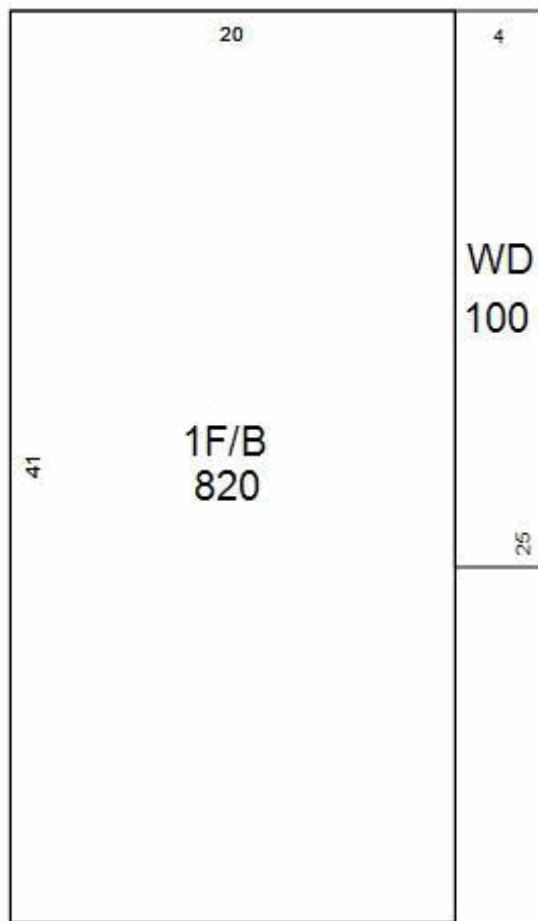

HOUSE #2

2023 Property Records for Village of Glenbeulah, Sheboygan County

October 31, 2023

# of identical OBIs: 1		Other Building Improvement (OBI)		
Main Structure		Modifications (Type, Size)		Photograph
OBI type: Garage	Width: 20 LF	Grade: C		
Const type: Detached, frame or cb	Depth: 20 LF	Condition: Good		
Year built: 1975	Floor area: 400 SF	% complete: 100%		
		Assessed \$: \$6,700		

Building Permits				
Issued	Permit #	Purpose	\$ Amount	Completed
6/10/2015	GLEN-15-06	Roofing	\$8,500	11/18/2015

Sales History		
Date	Price	Type
7/7/2004	\$212,500	Valid improved sale