

2023 Property Records for Town of Lyndon, Sheboygan Country

September 25, 2024

Tax key number: 59010131080

Property address: W6424 Lake Ellen Dr

Traffic / water / sanitary: Light / Well water / Sanitary District

Summary of Assessment	
Land	\$77,800
Improvements	\$131,200
Total value	\$209,000

Land									
Qty	Land Use	Width	Depth	Square Feet	Acres	Water Frontage	Tax Class	Special Tax Program	Assess Value
1	Residential	50	128			Lake (Prime)	Residential		\$77,800

Residential Building			
Year built:	1940	Full basement:	576 SF
Year remodeled:		Crawl space:	
Stories:	1 story	Rec room (rating):	
Style:	Cottage	Fin bsmt living area:	480 SF
Use:	Single family	First floor:	576 SF
Exterior wall:	Alum/vinyl	Second floor:	
Masonry adjust:		Third floor:	
Roof type:	Asphalt shingles	Finished attic:	
Heating:	Gas, forced air	Unfinished attic:	
Cooling:	No A/C	Unfinished area:	
Bedrooms:	2	Patio	216 SF
Family rooms:		Enclosed porch	180 SF
Baths:	1 full, 0 half		
Other rooms:	2		
Whirl / hot tubs:			
Add'l plumb fixt:			
Masonry FPs:	1 stacks, 2 openings		
Metal FPs:			
Gas only FPs:		Grade:	C
Bsmt garage:		Condition:	Good
Shed dormers:		Energy adjustment:	No
Gable/hip dorm:		Percent complete:	100%



Total living area is 1,056 SF; building assessed value is \$131,200

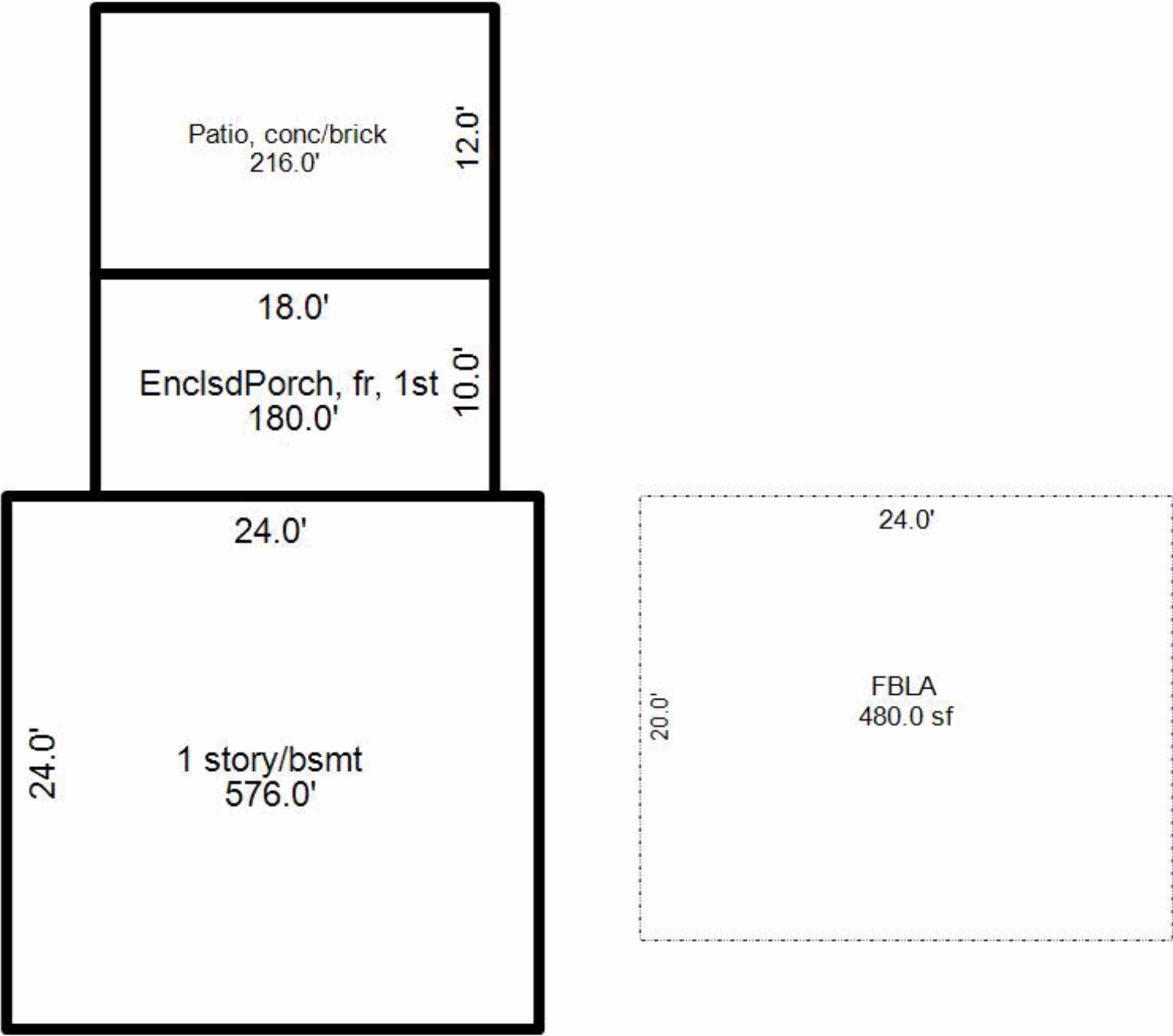

2023 Property Records for Town of Lyndon, Sheboygan Country

September 25, 2024

Building Permits				
Issued	Permit #	Purpose	\$ Amount	Completed

Sales History		
Date	Price	Type
4/14/2017	\$225,000	Valid improved sale