

2024 Property Records for Town of Russell, Sheboygan Country

September 4, 2024

Tax key number: 59020283840

Property address: W9130 River Ln

Traffic / water / sanitary: Light / Well water / Septic

Summary of Assessment	
Land	\$24,800
Improvements	\$120,500
Total value	\$145,300

Land									
Qty	Land Use	Width	Depth	Square Feet	Acres	Water Frontage	Tax Class	Special Tax Program	Assess Value
1	Residential			64,033	1.470	None	Residential		\$24,800

Residential Building			
Year built:	1900	Full basement:	840 SF
Year remodeled:		Crawl space:	
Stories:	2 story	Rec room (rating):	
Style:	Residence O/S	Fin bsmt living area:	
Use:	Single family	First floor:	888 SF
Exterior wall:	Alum/vinyl	Second floor:	744 SF
Masonry adjust:		Third floor:	
Roof type:	Asphalt shingles	Finished attic:	
Heating:	Gas, forced air	Unfinished attic:	
Cooling:	A/C, same ducts	Unfinished area:	
Bedrooms:	3	Open porch	95 SF
Family rooms:			
Baths:	1 full, 1 half		
Other rooms:	4		
Whirl / hot tubs:			
Add'l plumb fixt:	1		
Masonry FPs:			
Metal FPs:			
Gas only FPs:		Grade:	C-
Bsmt garage:		Condition:	Good
Shed dormers:		Energy adjustment:	No
Gable/hip dorm:		Percent complete:	100%



Total living area is 1,632 SF; building assessed value is \$101,700

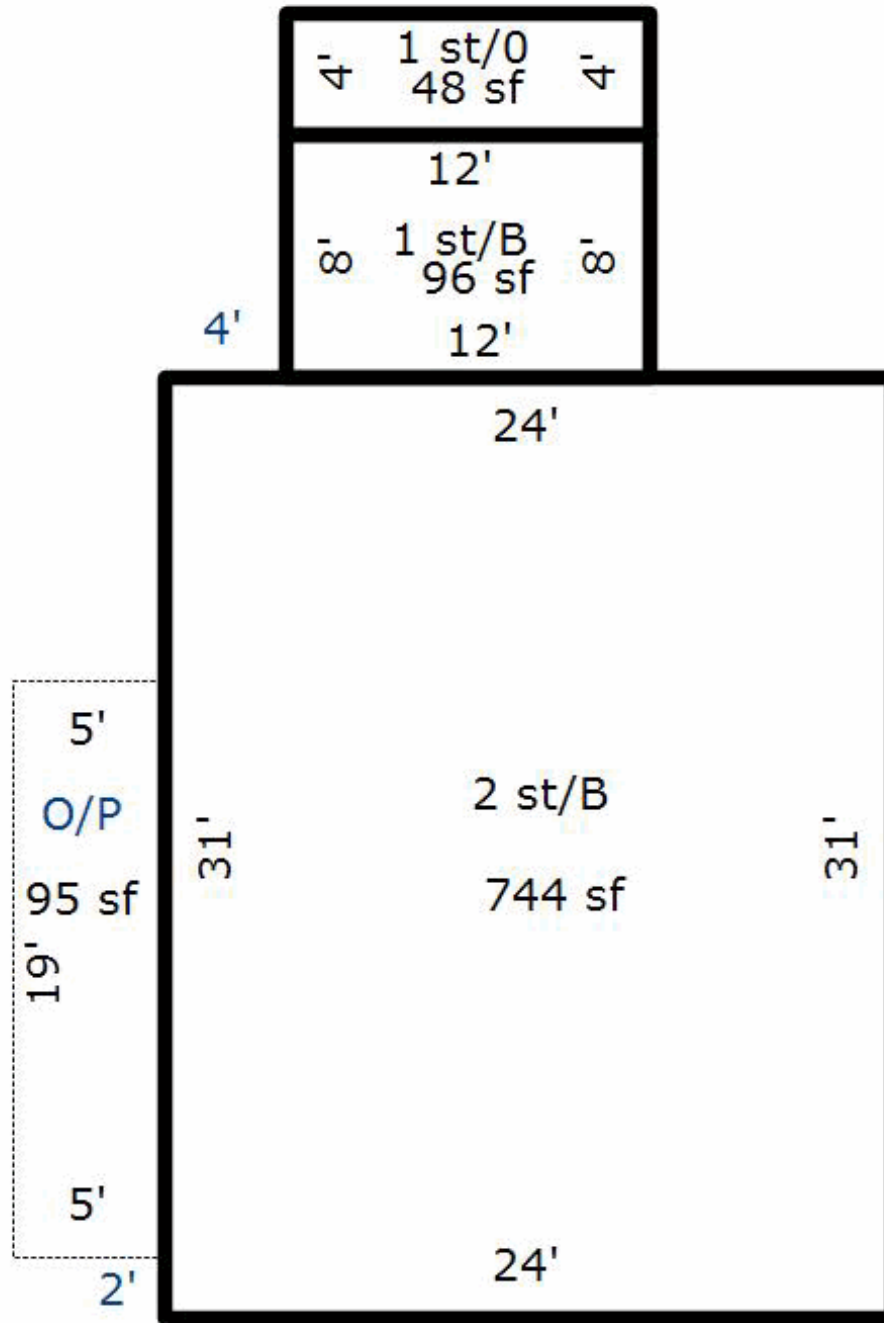

2024 Property Records for Town of Russell, Sheboygan Country

September 4, 2024

# of identical OBIs: 1		Other Building Improvement (OBI)		
Main Structure		Modifications (Type, Size)		Photograph
OBI type: Garage	Width: 24 LF	Grade: C		not available
Const type: Detached, frame or cb	Depth: 80 LF	Condition: Average		
Year built: 1950	Floor area: 1,920 SF	% complete: 100%		
		Assessed \$: \$15,400		

# of identical OBIs: 1		Other Building Improvement (OBI)		
Main Structure		Modifications (Type, Size)		Photograph
OBI type: Lean-to	Width: 12 LF	Grade: C		not available
Const type: Wood frame, wood siding	Depth: 36 LF	Condition: Average		
Year built: 1940	Floor area: 432 SF	% complete: 100%		
	Height: 12 LF	Assessed \$: \$700		

# of identical OBIs: 1		Other Building Improvement (OBI)		
Main Structure		Modifications (Type, Size)		Photograph
OBI type: Barn, general purpose	Width: 30 LF	Grade: C		not available
Const type: Bank, wood	Depth: 56 LF	Condition: Average		
Year built: 1900	Floor area: 1,680 SF	% complete: 100%		
	Height: 24 LF	Assessed \$: \$2,700		

Building Permits				
Issued	Permit #	Purpose	\$ Amount	Completed
5/5/2008		Replace 4 garage doors	\$2,500	1/1/2009

Sales History		
Date	Price	Type
8/27/2014	\$153,000	Valid improved sale