

2024 Property Records for Town of Plymouth, Sheboygan Country

September 25, 2024

Tax key number: 59016210690

Property address: N7036 State Highway 57

Traffic / water / sanitary: Highway / Well water / Septic

Legal description: PRT NE SE, SEC 2, COM 833.7'S OF NE COR SD1/4, TH S 107', S89 DEG 16'W 458.74'M/L, N 281.5', N89 DEG 16'E 336.94' M/L TO WLY R/W LN STH 57, S 174.5', TH N89 DEG 16'E TO BEG, SUBJ TO HWY CONV REC V 359 P 657-58.

Summary of Assessment	
Land	\$65,500
Improvements	\$142,700
Total value	\$208,200

Land									
Qty	Land Use	Width	Depth	Square Feet	Acres	Water Frontage	Tax Class	Special Tax Program	Assess Value
1	Residential			128,938	2.960	None	Residential		\$65,500

Residential Building			
Year built:	1885	Full basement:	1,046 SF
Year remodeled:		Crawl space:	
Stories:	2 story	Rec room (rating):	
Style:	Residential O/S	Fin bsmt living area:	
Use:	Single family	First floor:	1,256 SF
Exterior wall:	Alum/vinyl	Second floor:	1,046 SF
Masonry adjust:	40 SF	Third floor:	
Roof type:	Metal Roof	Half story:	0 SF
Heating:	Gas, forced air	Finished attic:	
Cooling:	A/C, same ducts	Unfinished attic:	
Bedrooms:	4	Unfinished area:	
Family rooms:		Open porch	196 SF
Baths:	1 full, 1 half	Enclosed porch	132 SF
Other rooms:		Garage	748 SF
Whirl / hot tubs:			
Add'l plumb fixt:			
Masonry FPs:			
Metal FPs:			
Gas only FPs:			
Bsmt garage:		Grade:	C
Shed dormers:		Condition:	Average
Gable/hip dorm:		Percent complete:	100%



Total living area is 2,302 SF; building assessed value is \$133,000

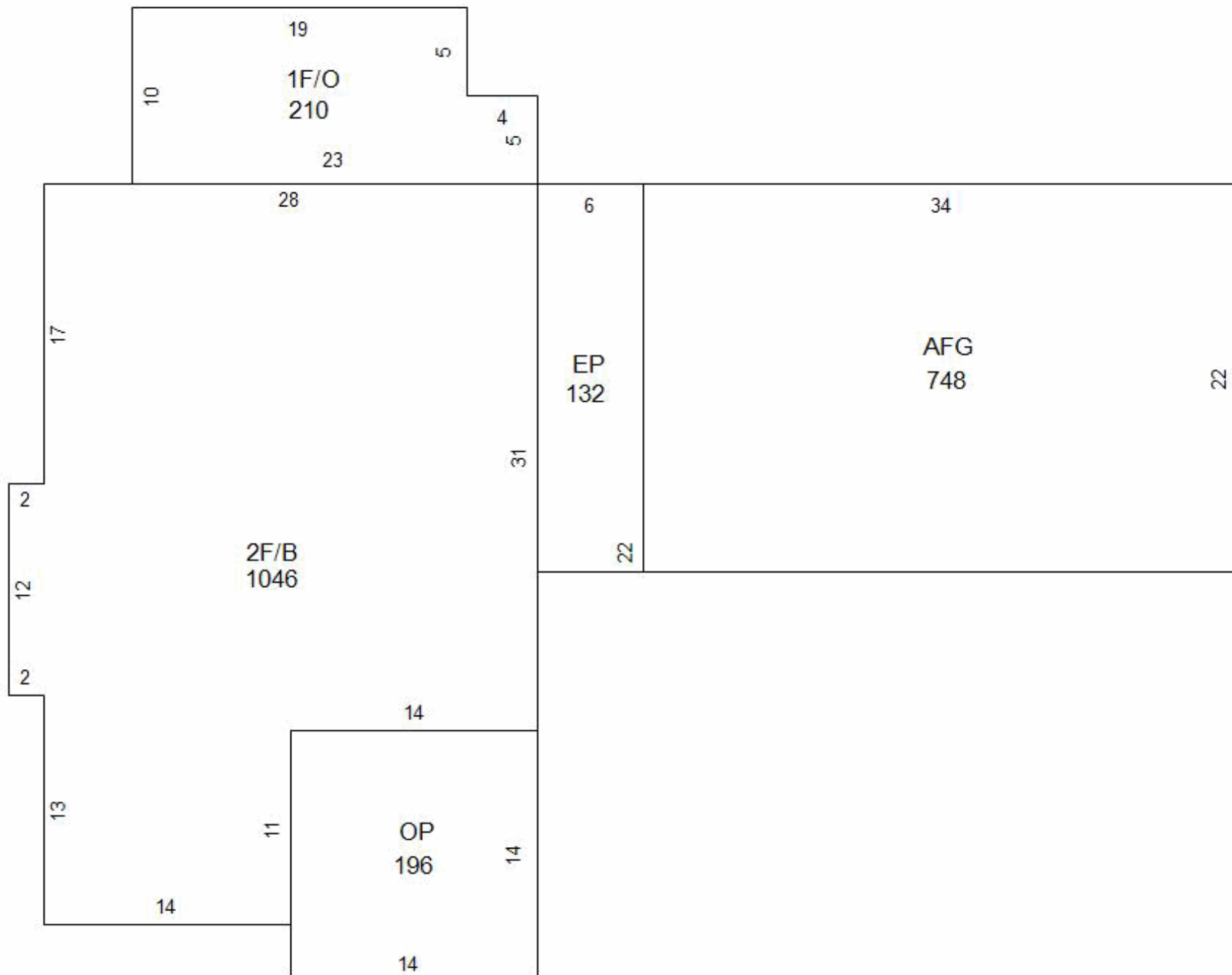

2024 Property Records for Town of Plymouth, Sheboygan Country

September 25, 2024

Other Building Improvement (OBI)				
Main Structure		Modifications (Type, Size)		Photograph
OBI type: Well Const type: Drilled Year built: 1885	Units: 1	Grade: C Condition: Average % complete: 100% Assessed \$: \$3,000		not available

Other Building Improvement (OBI)				
Main Structure		Modifications (Type, Size)		Photograph
OBI type: Septic System Const type: Conventional Year built: 1885	Units: 1	Grade: C Condition: Average % complete: 100% Assessed \$: \$3,000		not available

Other Building Improvement (OBI)				
Main Structure		Modifications (Type, Size)		Photograph
# of identical OBIs: 1				
OBI type: Utility shed, residential Const type: Frame Year built: 1960	Width: 30 LF Depth: 35 LF Floor area: 1,050 SF	Grade: C Condition: Fair % complete: 100% Assessed \$: \$3,400		

Other Building Improvement (OBI)				
Main Structure		Modifications (Type, Size)		Photograph
# of identical OBIs: 1				
OBI type: Utility shed, residential Const type: Frame Year built: 1970	Width: 8 LF Depth: 8 LF Floor area: 64 SF	Grade: C Condition: Average % complete: 100% Assessed \$: \$300		