

2024 Property Records for Town of Greenbush, Sheboygan Country

August 6, 2024

Tax key number: 59002007250

Property address: N5033 County Rd U

Traffic / water / sanitary: Light / Well water / Septic

Legal description: NW SW, SEC 33, EXC COM S89 DEG 23'W 2394.08' & S0 DEG 37'E 55' FROM CEN SD SEC, TH N89 DEG 23'E 213.79', S7 DEG 31' 34"E 639.77', N89 DEG 20'04"W 513.52' CEN CTH U, N4 DEG 07'54"W 279.5' ON CEN SD HWY, N85 DEG 52'06"E 24.75' TO ELN CTH U, N21 DEG 52'10"E 47.69...

Summary of Assessment	
Land	\$70,400
Improvements	\$269,900
Total value	\$340,300

Land									
Qty	Land Use	Width	Depth	Square Feet	Acres	Water Frontage	Tax Class	Special Tax Program	Assess Value
1	Residential			110,207	2.530	None	Residential		\$39,700
1	2nd grade tillable			174,240	4.000	None	2nd grade tillable		\$600
1	3rd grade tillable			261,360	6.000	None	3rd grade tillable		\$700
1	Secondary forest			826,333	18.970	None	Ag use forest		\$29,400

Residential Building			
Year built:	2001	Full basement:	1,744 SF
Year remodeled:		Crawl space:	
Stories:	1 Story	Rec room (rating):	
Style:	Ranch (1970+)	Fin bsmt living area:	1,308 SF
Use:	Single family	First floor:	1,744 SF
Exterior wall:	Alum/vinyl	Second floor:	
Masonry adjust:		Third floor:	
Roof type:	Asphalt Shingles	Finished attic:	
Heating:	Gas, forced air	Unfinished attic:	
Cooling:	A/C (same ducts)	Unfinished area:	
Bedrooms:	4	Open porch	60 SF
Family rooms:		Enclosed porch	168 SF
Baths:	3 full, 0 half	Deck	280 SF
Other rooms:		Patio	96 SF
Whirl / hot tubs:		Garage	954 SF
Add'l plumb fixt:	1		
Masonry FPs:			
Metal FPs:	1 stacks, 1 openings		
Gas only FPs:		Grade:	C+
Bsmt garage:		Condition:	Good
Shed dormers:		Energy adjustment:	No
Gable/hip dorm:		Percent complete:	100%



Total living area is 3,052 SF; building assessed value is \$264,500

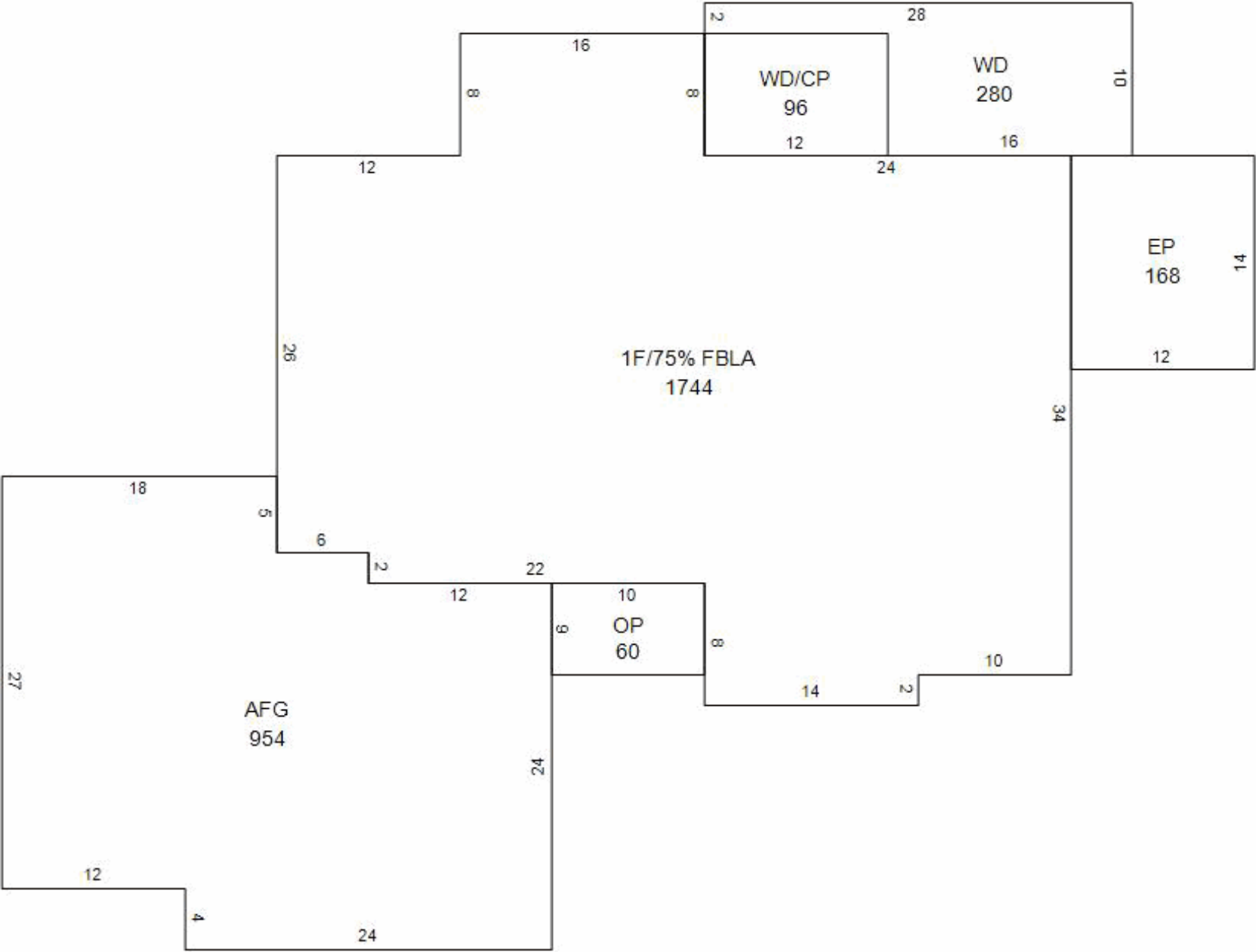

2024 Property Records for Town of Greenbush, Sheboygan Country

August 6, 2024

# of identical OBIs: 1		Other Building Improvement (OBI)		
Main Structure		Modifications (Type, Size)		Photograph
OBI type: Utility shed, residential	Width: 8 LF	Grade: C		
Const type: Frame	Depth: 8 LF	Condition: Average		
Year built: 2002	Floor area: 64 SF	% complete: 100%		
		Assessed \$: \$400		

Other Building Improvement (OBI)				
Main Structure		Modifications (Type, Size)		Photograph
OBI type: Well	Units: 1	Grade: C		not available
Const type: Drilled		Condition: Average		
Year built:		% complete: 100%		
		Assessed \$: \$2,500		

Other Building Improvement (OBI)				
Main Structure		Modifications (Type, Size)		Photograph
OBI type: Septic System	Units: 1	Grade: C		not available
Const type: Conventional		Condition: Average		
Year built:		% complete: 100%		
		Assessed \$: \$2,500		

Building Permits				
Issued	Permit #	Purpose	\$ Amount	Completed
4/4/2024	GB24-08	Post Frame Const. Shed	\$40,000	

Sales History		
Date	Price	Type
8/31/2018	\$500,000	Valid improved sale
6/21/2018	\$340,300	Not a market sale
6/7/2018	\$340,300	Not a market sale