

2024 Property Records for Town of Greenbush, Sheboygan Country

October 1, 2024

Tax key number: 59002008961

Property address: W9183 County Rd C

Traffic / water / sanitary: Medium / Well water / Septic

Legal description: B-1883 - PRT SW SW & SE SW, SEC 31,BEG AT SW COR SD SEC, TH N0 DEG 05'16"W 1094.3', N89 DEG 54'44"E 250',N0 DEG 05'16"W 228.81'TO CENLN CTH C,S49 DEG 28'E 7.16',SELY 232.03'ALG CURVE,SELY 233.94'ALG CURVE,S85 DEG 30'E 253.58',SELY 377.7'ALG CURVE,S70 D...

Summary of Assessment	
Land	\$87,800
Improvements	\$259,600
Total value	\$347,400

Land									
Qty	Land Use	Width	Depth	Square Feet	Acres	Water Frontage	Tax Class	Special Tax Program	Assess Value
1	Residential			161,172	3.700	None	Residential		\$37,100
1	2nd grade tillable			1,168,279	26.820	None	Undeveloped		\$42,900
1	3rd grade tillable			87,120	2.000	None	Undeveloped		\$3,000
1	Swamp 2			348,480	8.000	None	Undeveloped		\$4,800

Residential Building			
Year built: 2003	Full basement: 1,456 SF		
Year remodeled:	Crawl space:		
Stories: 1 Story w/attic	Rec room (rating):		
Style: Modern Two Story	Fin bsmt living area:		
Use: Single family	First floor: 1,456 SF		
Exterior wall: Wood	Second floor:		
Masonry adjust:	Third floor:		
Roof type: Asphalt Shingles	Finished attic: 512 SF		
Heating: Gas, forced air	Unfinished attic:		
Cooling: A/C (same ducts)	Unfinished area:		
Bedrooms: 3	Deck: 492 SF	<p>Total living area is 1,968 SF; building assessed value is \$241,400</p>	
Family rooms:	Patio: 226 SF		
Baths: 2 full, 0 half	Garage: 1,024 SF		
Other rooms:			
Whirl / hot tubs:			
Add'l plumb fixt:			
Masonry FPs:			
Metal FPs:			
Gas only FPs:	Grade: B-		
Bsmt garage:	Condition: Average		
Shed dormers:	Energy adjustment: No		
Gable/hip dorm: 6 LF	Percent complete: 100%		

8961

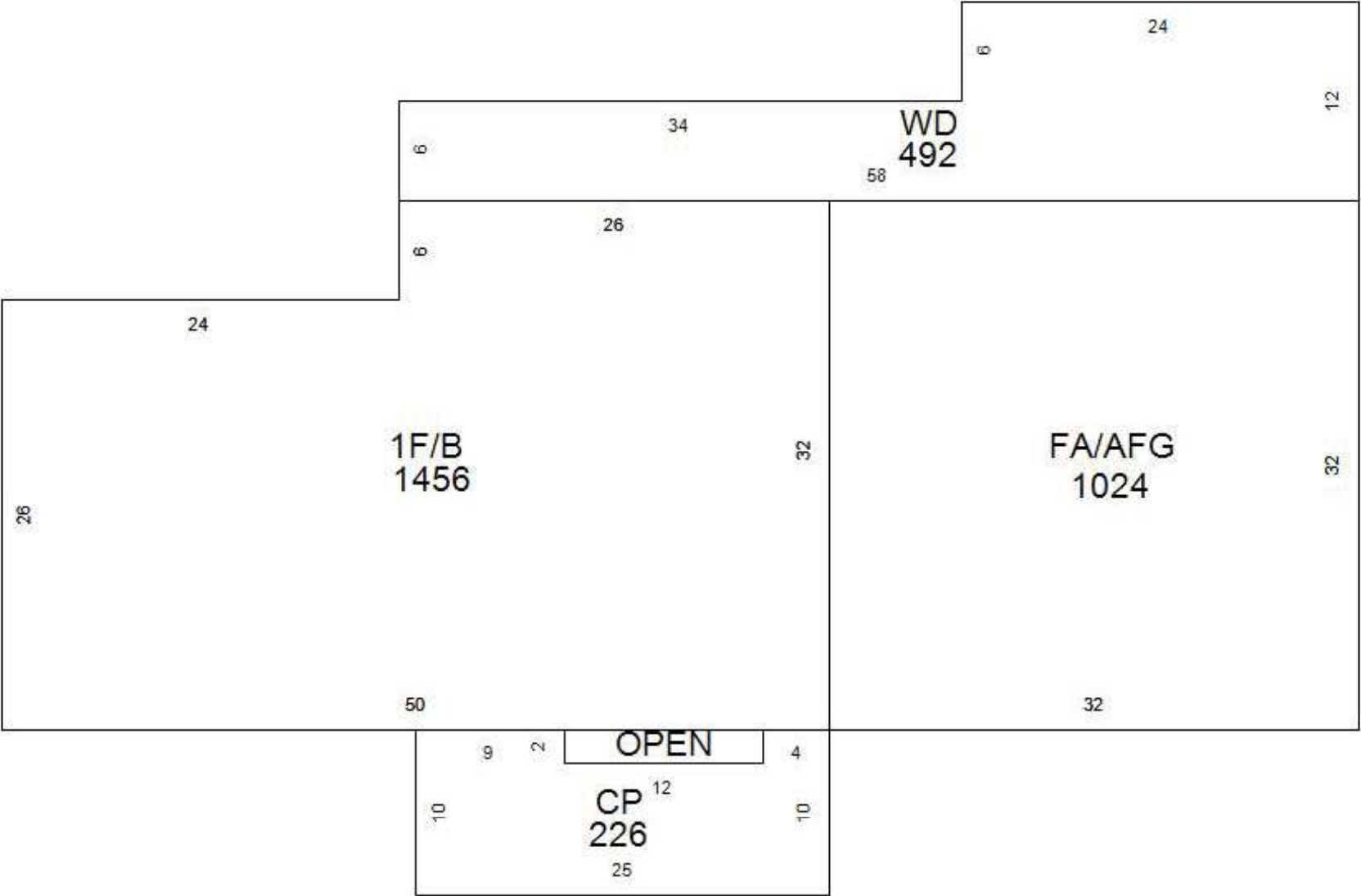

2024 Property Records for Town of Greenbush, Sheboygan Country

October 1, 2024

# of identical OBIs: 1		Other Building Improvement (OBI)		
Main Structure		Modifications (Type, Size)		Photograph
OBI type: Farm utility building, pole	Width: 48 LF	Grade: C	Overhead door, 9 x 7	
Const type: Metal, 4 sides closed	Depth: 96 LF	Condition: Average	1	
Year built: 1997	Floor area: 4,608 SF	% complete: 100%		
	Height: 14 LF	Assessed \$: \$13,200		

Other Improvements		
Tax Class	Description	Assess Value
Residential	w/s	\$5,000

Building Permits				
Issued	Permit #	Purpose	\$ Amount	Completed

Sales History		
Date	Price	Type
4/15/2001	\$75,000	Not a market sale